

Key

01A ADVANCED WARNING ACCESS TO ROAD AHEAD CLOSED ON ____ TO ____ FOR ____ DAY(S) FROM ____ TO ____	01 ROAD CLOSED	02 Diverion ENDS	04 Diverted traffic	06 Diverted traffic	08 Diversion	10 ROAD AHEAD CLOSED	12 Diverted traffic	14 Diverted traffic	15 CHURCH LANE CLOSED FOLLOW DIVERSION
		03 Diverion ENDS	05 Diverted traffic	07 Diversion	09 Diversion	11 Diverted traffic	13 Diverted traffic		

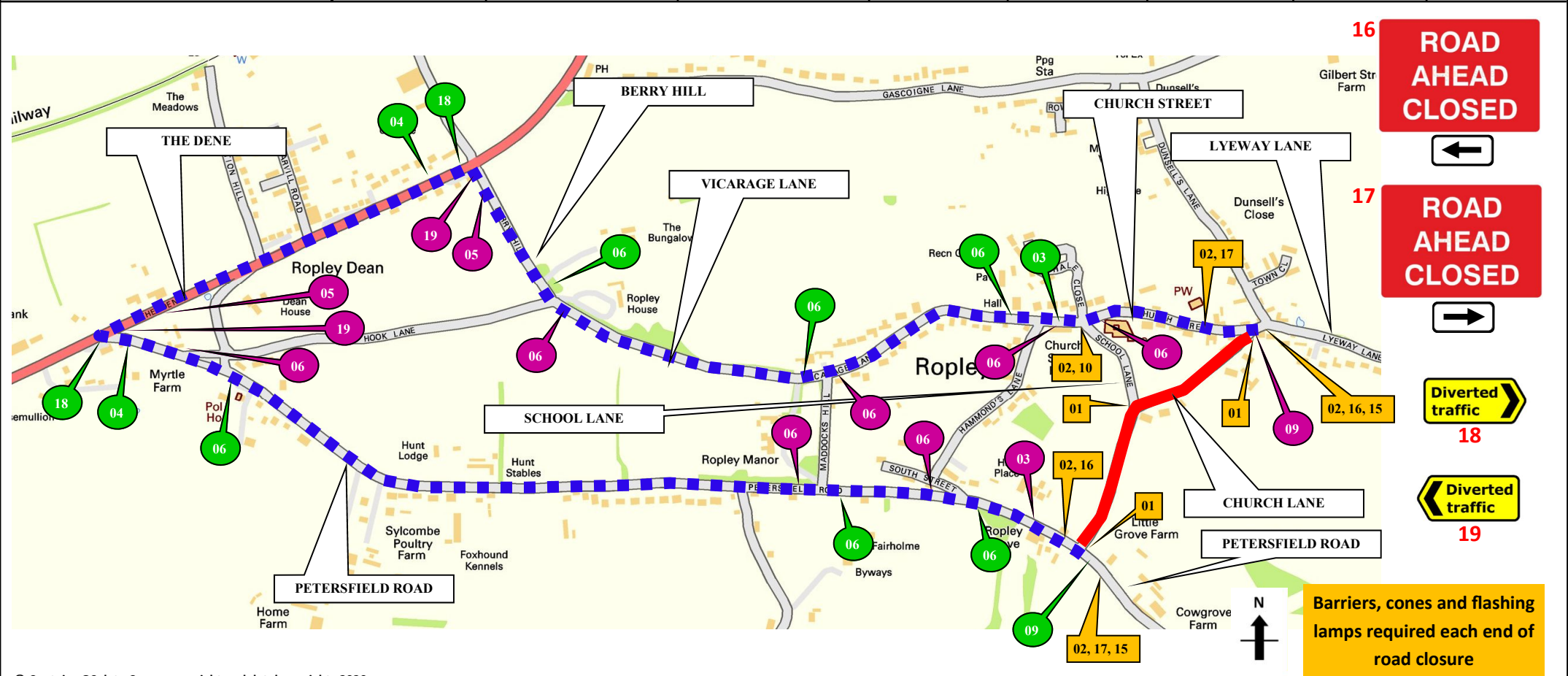

© Contains OS data Crown copyright and database rights 2020



Sunbelt Rentals UK (Traffic Management)
Kemble Airfield Enterprise Park
Cirencester Road
Kemble
GL7 6BQ
☎ 03700 500 792
📠 0845 004 7105

Note

- All equipment shall be approved and shall comply with the Department Of Transport specification MCE0111. This drawing does not show the normal road works signage that will be required as per Chapter 8.
 - All signs to be in accordance with TSGRD 2002 and to minimum class retroreflective.
 - Minimum height of lettering to be 60mm and sign boards to be 1000mm (750mm where appropriate).
- This drawing is protected by copyright and the information contained therein is confidential.
- This drawing may not be copied and the information therein may not be used, or disclosed to a third party, wholly or in part with the written permission of Sunbelt Rentals UK (Traffic Management).

CROWN COPYRIGHT DATA REPRODUCED BY PERMISSION OF THE CONTROLLER OF HMSO

CLIENT DETAILS OPENREACH	REP/DEPOT 228	DRAWN BY SR	ADDRESS CHURCH LANE ALRESFORD SO24 0EG		
AMEND # 00	SHEET # 1 OF 2	DATE 25/06/2020			
TIME OF WORKS					
OFF PEAK 0930-1530	NIGHT 2100-0600	WEEKEND SAT/SUN	WEEKDAY MON-FRI	24HR WORKS	
✓					BUS ROUTE AFFECTED

ROAD CLOSURE	CLOCKWISE DIVERSION
DIVERSION	ANTI-CLOCKWISE DIVERSION
ROAD CLOSURE SIGN	
ROAD CLOSURE LENGTH (APPROX)	500M
ROAD CLOSURE WIDTH (APPROX)	4M
HIRE ADVICE	228-S006974